

Land Transfer Office
Received M. G. Smith's Affidavit
Title Reference Pt. CT. 2002/68
Abt. 1234. K.L. 10.0
Referred to CT Surveyor

Re ROW	Colour	Signified	Dimensions
Pt Lot 28	Yellow	Lot 28	Lot 28
Pt Lot 29	Blue	Lot 29	Lot 29
Pt Lot 30	Red	Lot 30	Lot 30
Pt Lot 31	Green	Lot 31	Lot 31



s9899

s9899
Hamilton City

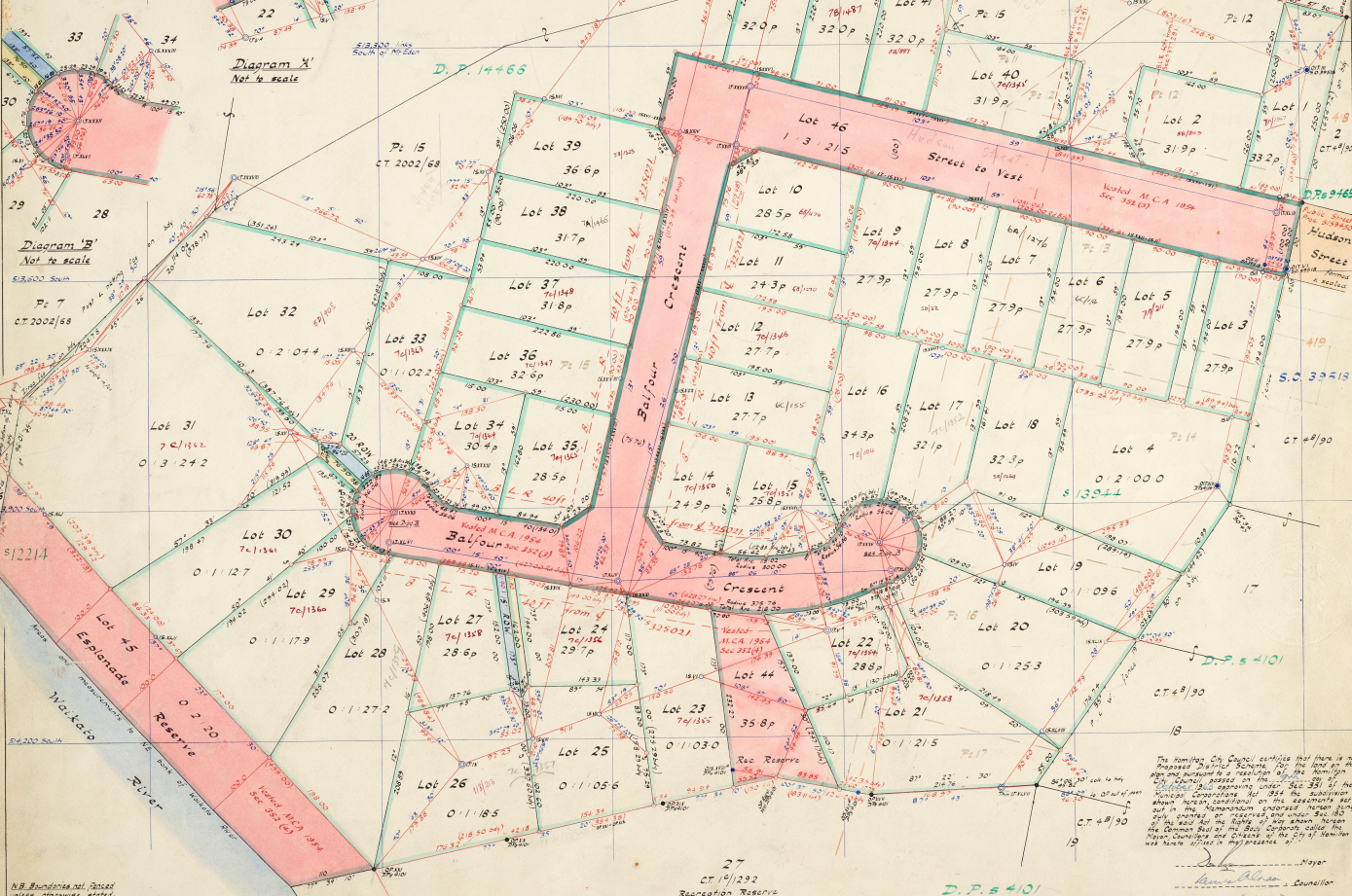

Total Area: 13 2 26.1

Subdivision of Pts Allots 256 c 257 Kiriakira Parish
(Formerly Pts Lots 7, 9, 11 - 17 D.P. 14466)

Comprised in CT 2002/68
Block 11 Hamilton Survey District
South Auckland Land District - Hamilton City Council
Scale 60 Links to an inch - Surveyed by Thomson & Farrer - Date: May 1965

Approved as to Survey
Chief Surveyor
Reference Plans
Field Book 108 a 49-56
Traverse Book 422 a 130-140
Examined by Supt. Registrar
Recorded Hamilton City
Corrected Hamilton City
for L.T. Surveyor

s9899

I, Walter Norman Vautier, of Hamilton, Registered Surveyor and holder of an annual practicing certificate do solemnly and sincerely declare that this plan has been made from surveys executed by me that each plot and survey are correct and have been made in accordance with the regulations under the Survey Act 1952 and I make this solemn declaration conscientiously aware of the penalty imposed by law for making a false and untrue declaration.

Declared at _____ this _____ day of _____ 1965

_____ Registered Surveyor

Justice of the Peace or Solicitor

Approved
Applicant or Registered Owner

s9899